

Variation of Condition No.23 (e) of Planning Permission SS.16/10/602 MW to Allow Additional Two Concrete Mixer Lorries to Enter & Leave the Site Outside of Normal Operation Hours

Approved Site Traffic Route

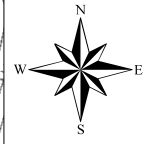
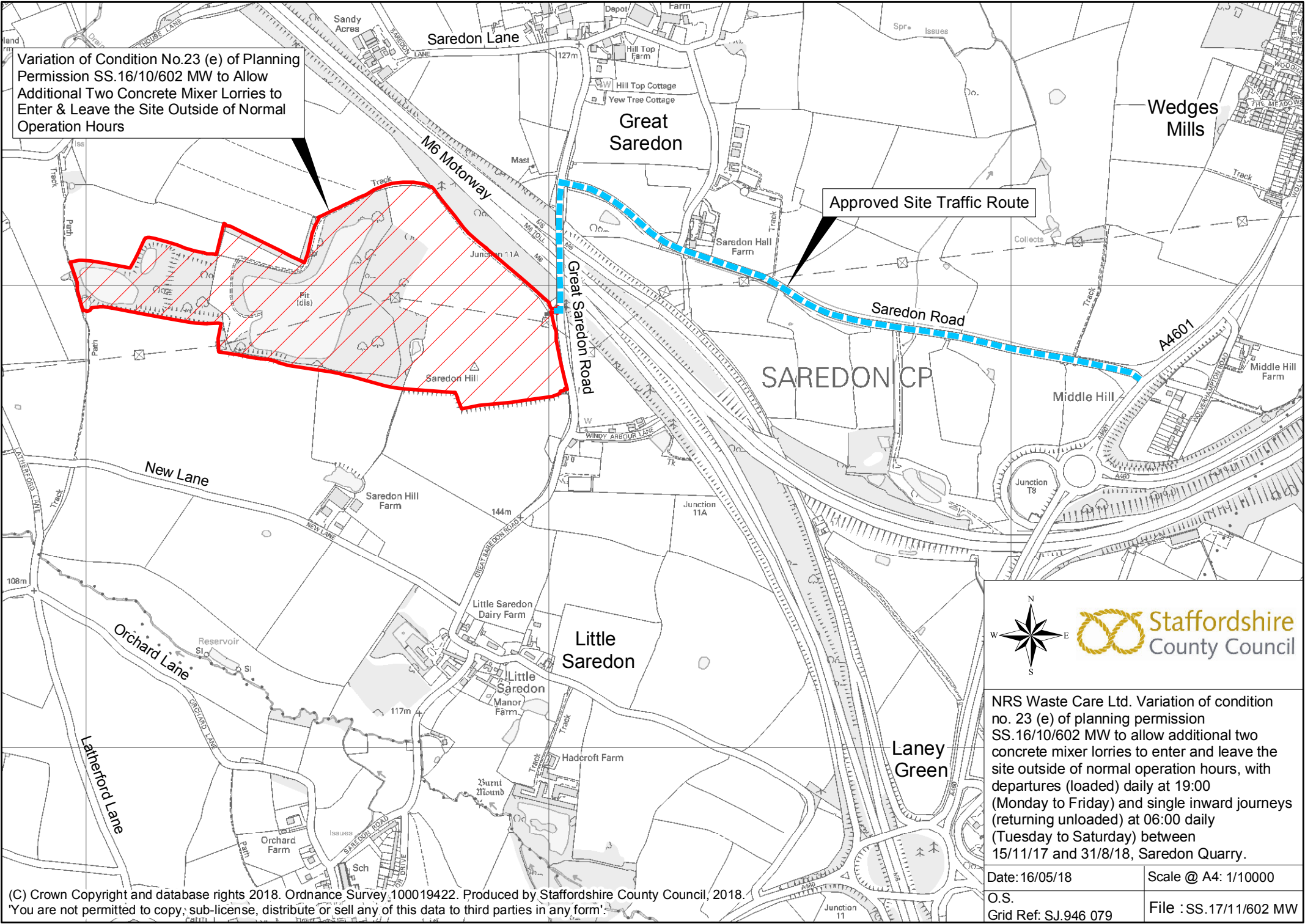

NRS Waste Care Ltd. Variation of condition no. 23 (e) of planning permission SS.16/10/602 MW to allow additional two concrete mixer lorries to enter and leave the site outside of normal operation hours, with departures (loaded) daily at 19:00 (Monday to Friday) and single inward journeys (returning unloaded) at 06:00 daily (Tuesday to Saturday) between 15/11/17 and 31/8/18, Saredon Quarry.

Date: 16/05/18	Scale @ A4: 1/10000
O.S.	File : SS.17/11/602 MW
Grid Ref. SJ.946 079	